

I-Port™ Subcutaneous Injection Port Short User Instructions

These instructions are extracted from the manufacturer's Instructions For Use (IFU). You should familiarise your self with the IFU before using this device.

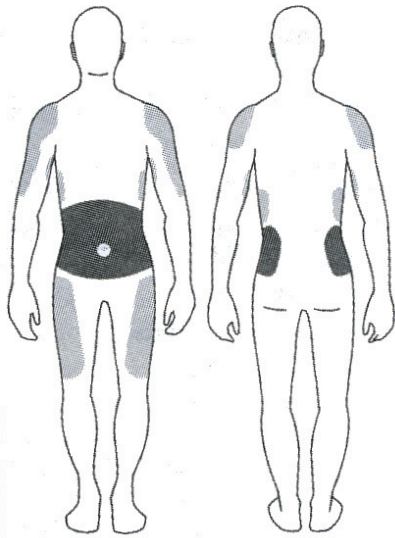

The illustration demonstrates the most usual areas for insertion. Where possible the darker areas should be used for preference.

Avoid the area immediately around the navel, and any area which may lie under a belt or clothing waist band.

Before using the device you should wash your hands and cleanse the injection site according to the local instructions provided by your care team.

Inspect the device packaging to make sure it is fully intact, and then remove the device taking care not to dislodge the needle guard.

Follow the steps below to insert the device into the chosen location.

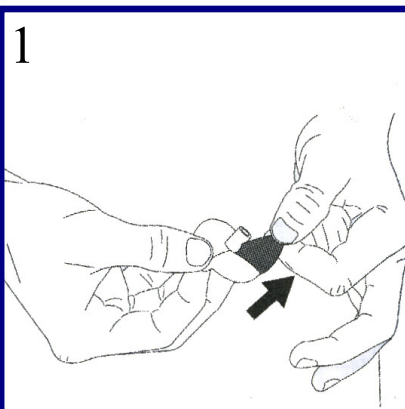

1
Remove the protective backing from the adhesive pad.

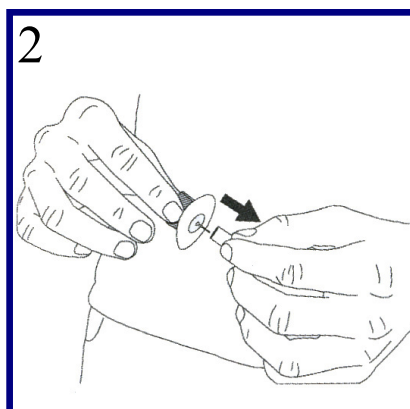

2
Remove the needle guard without touching the needle with your fingers.

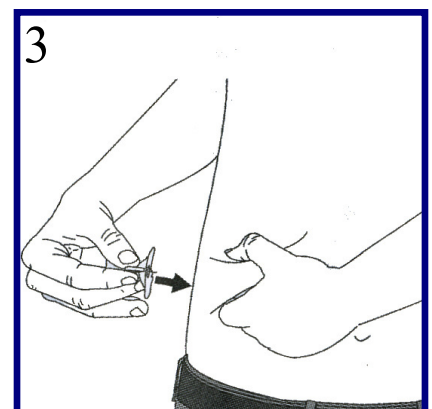

3
Pinch the skin in preparation for insertion of the I-Port.

Apply the I-Port by inserting the the introducer needle and cannula into the tissue using a fast, non-stop motion. Use sufficient force to fully insert the needle and cannula into the tissue. Failure to fully insert the cannula into the tissue can affect device performance.

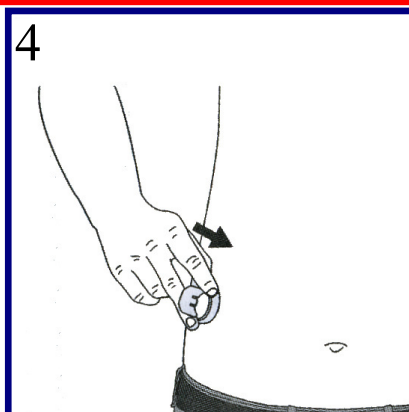

4
Carefully smooth the tape to ensure full retention of the I-Port against the skin.

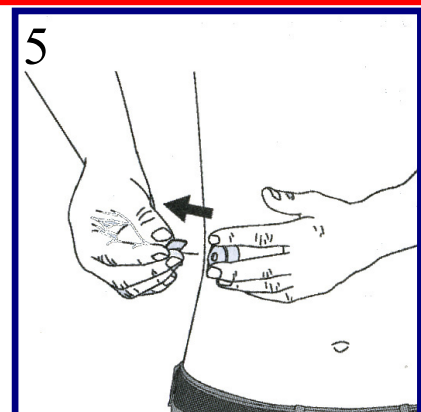

5
Hold the I-Port firmly while withdrawing the introducer needle.

After use carefully dispose of the needle and any contaminated items.

Injecting with the I-Port

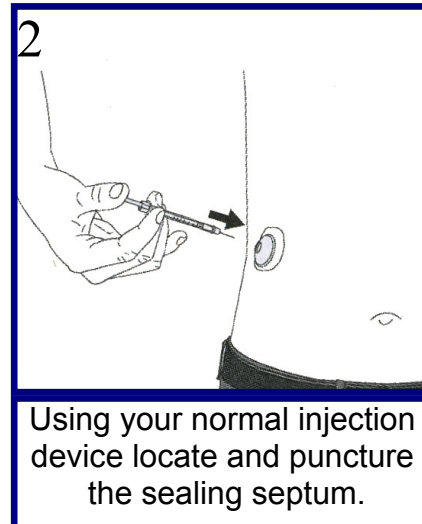
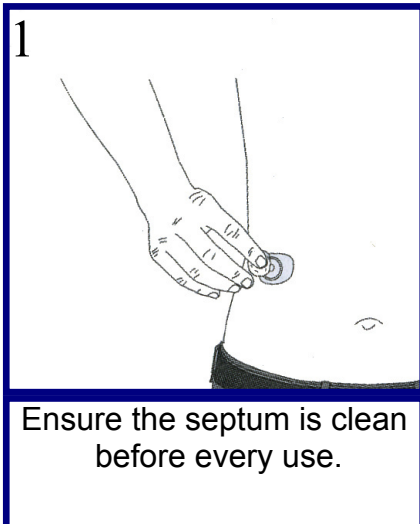

Note: Do not use a needle longer than 5/16th inch or 8mm in length to puncture the device membrane.

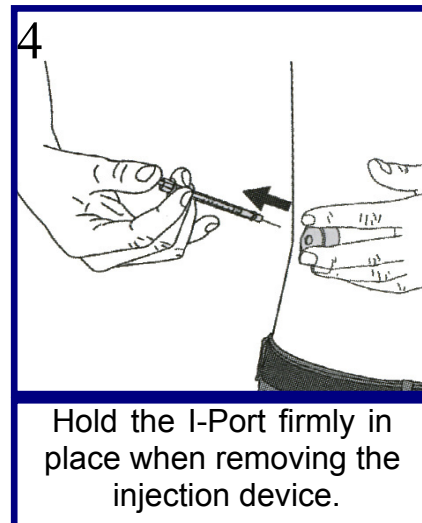
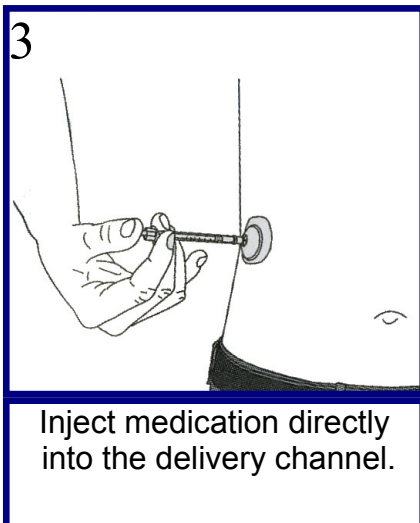

Removing the I-Port

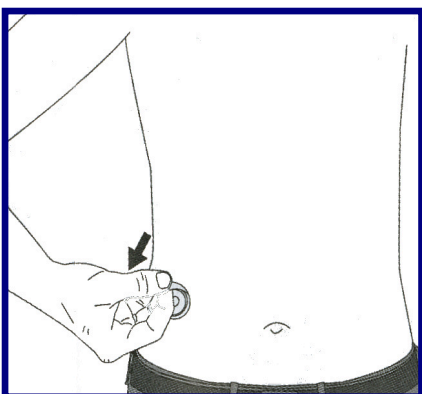

Grab an outer edge of the adhesive tape and pull in one direction until the device is removed from the body. Cleanse the area according to your care team advice.

Dispose of all contaminated materials according to the instructions of your care team.

Applied Medical Technology Ltd

4 Orwell Furlong, Cowley Road Cambridge CB4 0WY

Phone: 01223 420415

sales@applied-medical.co.uk

Fax 01223 425533