



Neria Infusion Set

Abbreviated Instructions

Note: These are training notes to aid in safe use of the infusion set. They do not form part of the formal documentation for the device and users should familiarise themselves with the full manufacturers instructions contained within each package of sets prior to use.

- 1 Inspect packing prior to use to ensure that it is intact with no risk of sterilisation failure
- 2 Remove set from packaging and discard packaging
- 3 Select an appropriate site bearing in mind the depth of penetration of the needle. Not recommended for chest wall applications, or where there is a risk of contacting bone during insertion

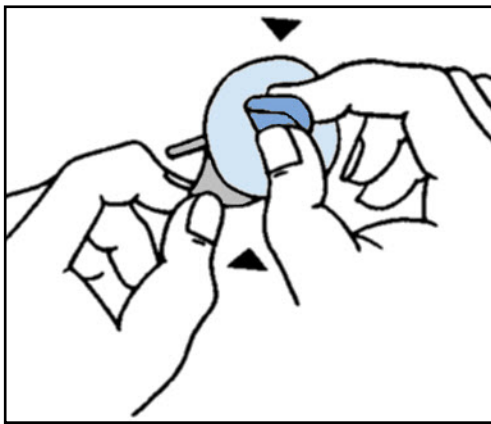

- 4 Remove tape dressing cover from the front of the infusion set

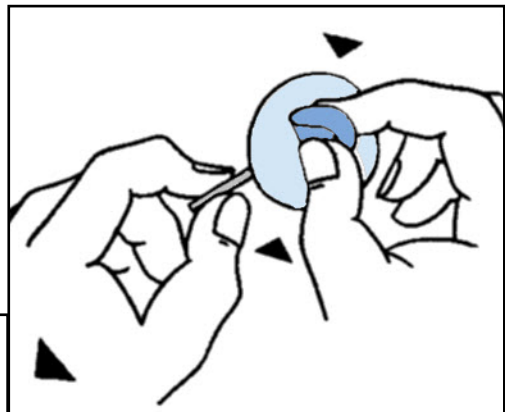

- 5 Remove Protective covering from needle taking care not to touch the needle

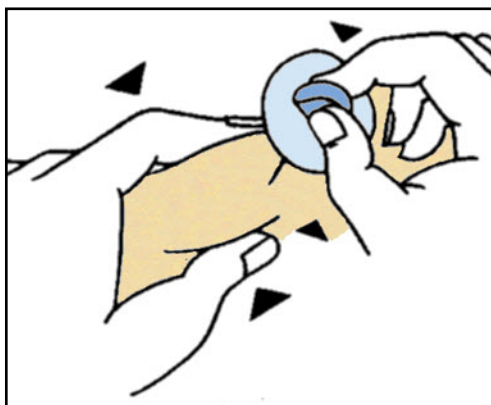

- 6 Pinch the skin and insert the needle with a firm motion vertically into the skin

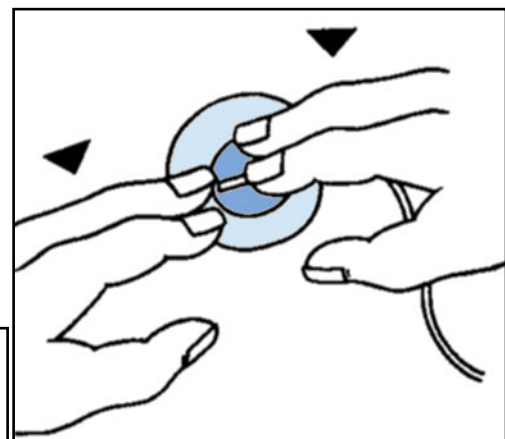

- 7 Press the set firmly down into the tissue to secure the adhesive

- 8 It is also recommended that the tubing should be secured by forming a loop approximately 2 inches from the site, and fixing this with a piece of tape.